

**PUBLIC PATH DIVERSION ORDER
HIGHWAYS ACT 1980**

HERTFORDSHIRE COUNTY COUNCIL

**Hertfordshire County Council
(Stapleford 14)
Diversion Order 2023**

This Order is made by Hertfordshire County Council ("the authority") under section 119 of the Highways Act 1980 ("the 1980 Act") because it appears to the authority that in the interests of the owner of the land crossed by the bridleway described in paragraph 1 of this Order it is expedient that the line of the way should be diverted.

Mr R. M. Abel Smith of The Estate Office, Woodhall Park, Watton-at-Stone has agreed to defray any compensation which becomes payable in consequence of the coming into force of this Order and any expenses which are incurred in bringing the new site of the way into a fit condition for use by the public.

East Hertfordshire District Council has been consulted as required by section 120(2) of the 1980 Act.

BY THIS ORDER:

1. The public right of way over the land situate at Great Gobions Farm in the Parish of Stapleford and shown by a bold continuous line on the plan contained in this Order ("the Order Plan") and described in Part 1 of the Schedule to this Order shall be stopped up on the date of confirmation of this Order.
2. There shall on the date of confirmation of this Order be a public bridleway over the land situate at Great Gobions Farm in the Parish of Stapleford described in Part 2 of the Schedule and shown by a bold broken line on the Order Plan.
3. The rights conferred on the public under this Order shall be subject to the limitations and conditions set out in Part 3 of the Schedule.

IN WITNESS whereof the COMMON SEAL of HERTFORDSHIRE COUNTY COUNCIL was hereunto affixed this 24th day of February 2023

The Common Seal of
HERTFORDSHIRE
COUNTY COUNCIL
was hereunto affixed
in the presence of:-

The foregoing Order is
hereby confirmed

Chief Legal Officer
Dated

24 February 2023
14th December 2023

mian Ogbonnaya
Principal Solicitor

Daniel Stevens
Principal Solicitor

This plan forms part of the Hertfordshire County Council (Stapleford 14) Diversion Order 2023



- Existing Bridleway
- Bridleway to be extinguished
- Bridleway to be created

Appears on DM Sheet No. 44

Scale 1:2500

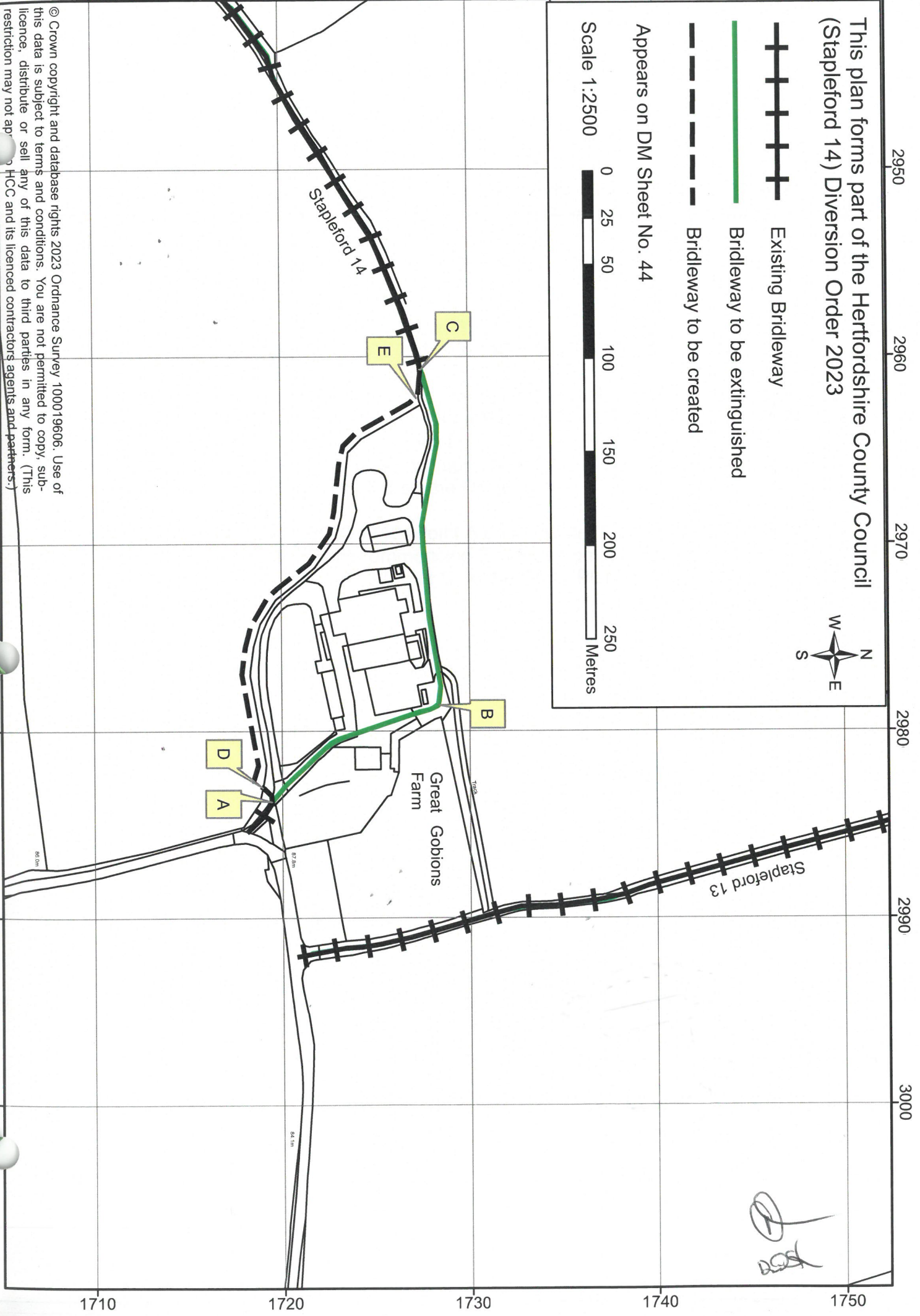

© Crown copyright and database rights 2023 Ordnance Survey 100019606. Use of this data is subject to terms and conditions. You are not permitted to copy, sub-licence, distribute or sell any of this data to third parties in any form. (This restriction may not apply to HCC and its licenced contractors agents and partners.)

SCHEDULE

PART 1

DESCRIPTION OF SITE OF EXISTING PATH OR WAY

The full width of that part of Stapleford Bridleway 14 commencing at TL 2983 1719 (Point A on the Order Plan) then north west along the driveway to Great Gobions Farmhouse passing west of the Farmhouse for approximately 110 metres to TL 2978 1728 (Point B on the Order Plan) then west passing north of the farmyard for approximately 185 metres to TL 2960 1727 (Point C on the Order Plan).

PART 2

DESCRIPTION OF SITE OF NEW PATH OR WAY

A public bridleway commencing from Stapleford Bridleway 14 and Gobions Lane (public highway) at TL 2983 1719 (Point A on the Order Plan), passing through a gap in the hedge on the field boundary at TL 2983 1718 (Point D on the Order Plan) then west and north west on the south side of the field boundary for approximately 270 metres to rejoin Stapleford Bridleway 14 at TL 2960 1727 (Point C on the Order Plan).

Width: 4 metres between TL 2983 1719 (Point A on the Order Plan) and TL 2960 1727 (Point C on the Order Plan) commencing 2 metres from the root of the boundary hedge between TL 2983 1718 (Point D on the Order Plan) and TL 2962 1727 (Point E on the Order Plan).

PART 3

LIMITATIONS AND CONDITIONS

Limitations: None